



Churchgate Street, Bury St. Edmunds, Suffolk, IP33 1RL

Rent - £525 PCM Deposit - £605

Shires are delighted to offer this room in a fully renovated shared house situated in the centre of Bury St Edmunds. The rent includes gas, water, electric, council tax, fibre-broadband and weekly cleaning of the communal areas. There is a large shared kitchen/living space and two bathrooms. The property is available immediately.

- ROOM IN SHARED PROPERTY
- COMMUNAL KITCHEN/SITTING ROOM
- MEDIEVAL GRID LOCATION
- AVAILABLE NOW
- THREE STOREY TOWN HOUSE
- SHARED BATHROOM & SHOWER ROOM
- INCLUDES UTILITIES, FIBRE BROADBAND & CLEANING OF COMMUNAL AREAS

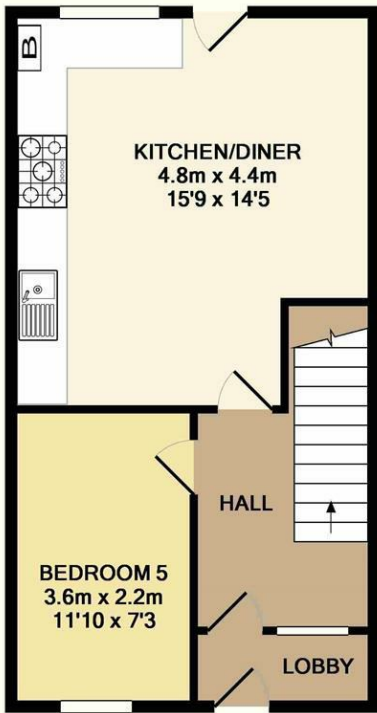

GROUND FLOOR

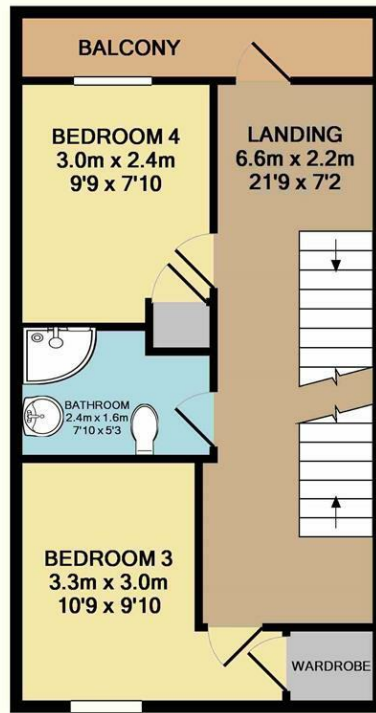

1ST FLOOR

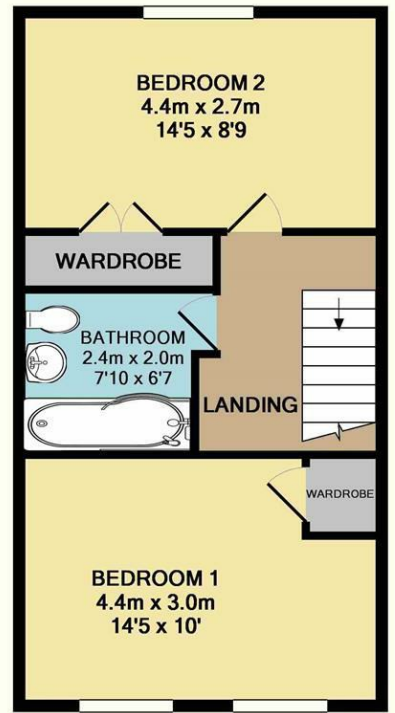

2ND FLOOR

Whilst every attempt has been made to ensure the accuracy of the floor plan contained here, measurements of doors, windows, rooms and any other items are approximate and no responsibility is taken for any error, omission, or mis-statement. This plan is for illustrative purposes only and should be used as such by any prospective purchaser. The services, systems and appliances shown have not been tested and no guarantee as to their operability or efficiency can be given
Made with Metropix ©2018

